

# GLASS FIBER OPTIC CABLES

Application oriented standard production optical fiber cable:





- ◆ Reflex scanner straight and right-angle.
- ◆ Multiple reflex scanners.
- ◆ V-scanner and multi-V-scanner.
- ◆ Optical OR-scanner.
- ◆ One way light barriers straight and right-angle.
- ◆ Two way light barriers.
- ◆ Multiple light barriers.
- ◆ Parallel light beams.
- ◆ Light couplers.
- ◆ U-shape light barriers.
- ◆ Threaded fiber tips.

Sensing distance/range:

- ◆ Light barriers: sensing range to 3000 millimeters.
- ◆ Reflex-scanners: sensing range to 500 millimeters.
- ◆ The rated sensing distance or range is based on a light wave conductor length of 2 meters.

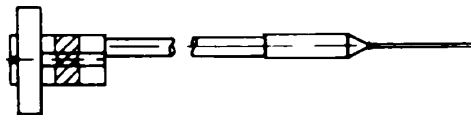
... adapted to suit the ambient conditions of the operational area:

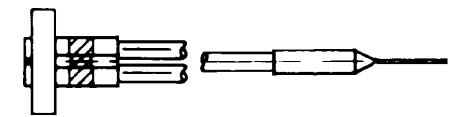
- ◆ For welding systems.
- ◆ Enclosure to IP 67.
- ◆ Resistance to chemicals.
- ◆ High thermal load capacity.
- ◆ High mechanical flexibility and motion capacity.
- ◆ Resistant to temperatures up to 300°C.

Scanning range mm		Type Optical Fiber	Ordering Reference	Fixing Clamp	
FMS 18	FMS 30				
<b>Glass Fiber Optics Reflex-Scanner Axial</b>					<p>Reflex-Scanner Axial</p> 
1	3	0.5	18/30 R 0.5/...-Si	Z6	
5	15	1	18/30 R 1/...-Si	Z6	
5	15	1.5	18/30 R 1.5/...-Si	Z6	
15	30	2	18/30 R 2/...-Si	Z8	
60	100	3	18/30 R 3/...-Si	Z8	
	200	4	30 R 4/...-Si	Z10	
	500	12	30 R 12/...-Si	Z12	
<b>Glass Fiber Optics Reflex-Scanner Radial</b>					<p>Reflex-Scanner Radial</p> 
5	15	1	18/30 RZ 1/...-Si, Ls =	Z6	
15	30	2	18/30 RZ 2/...-Si, Ls =	Z8	
60	100	3	18/30 RZ 3/...-Si, Ls =	Z8	
	200	4	30 RZ 4/...-Si, Ls =	Z10	
	500	12	30 RZ 12/...-Si, Ls =	Z12	
<b>Glass Fiber Optics Light Barriers Axial</b>					<p>Light Barrier Axial</p> 
10	20	0.5	18/30 L 0.5/...-Si	Z6	
60	100	1	18/30 L 1/...-Si	Z6	
60	100	1.5	18/30 L 1.5/...-Si	Z6	
100	200	2	18/30 L 2/...-Si	Z6	
300	500	3	18/30 L 3/...-Si	Z8	
	1500	4	30 L 4/...-Si	Z10	
	3000	12	30 L 12/...-Si	Z10	
<b>Glass Fiber Optics Light Barriers Radial</b>					<p>Light Barrier Radial</p> 
60	100	1	18/30 LZ 1/...-Si, Ls =	Z6	
100	200	2	18/30 LZ 2/...-Si, Ls =	Z6	
300	500	3	18/30 LZ 3/...-Si, Ls =	Z8	
	1500	4	30 LZ 4/...-Si, Ls =	Z10	
	3000	12	30 LZ 12/...-Si, Ls =	Z10	

**Note:** Covering on all models is silicon covered stainless steel casing.



Locon Sensor Systems, Inc., P.O. Box 343, Perrysburg, Ohio, 43552  
 Phone: 800-356-2661 Fax: 216-359-0077 E-mail: Sales@Locon.net

# GLASS FIBER OPTIC CABLES - ALL MEASUREMENTS SHOWN IN MILLIMETERS

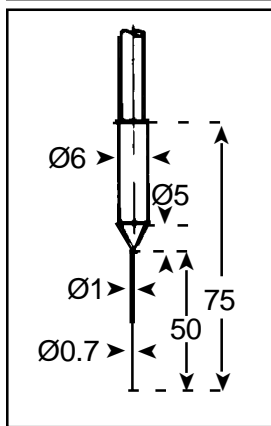

18/30 L/R .5 Si

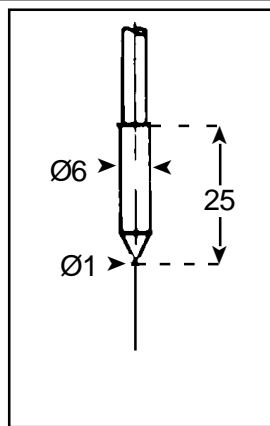

18/30 L/R 1.0 Si

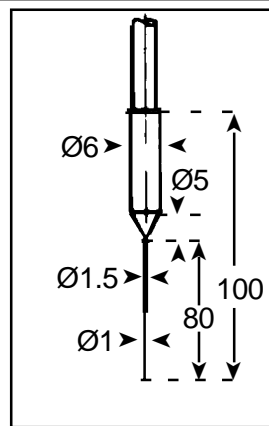

18/30 L/R 1.5 Si

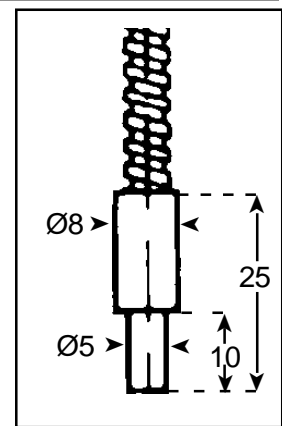

18/30 L/R 2.0 Si

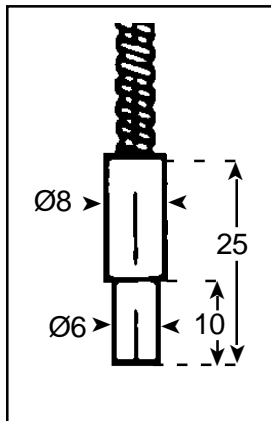

18/30 L/R 3 Si

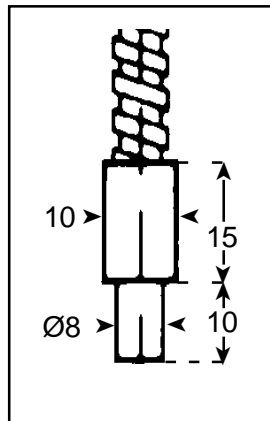

30 L/R 4 Si

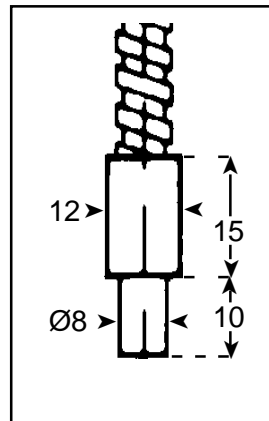

30 L/R 12 Si

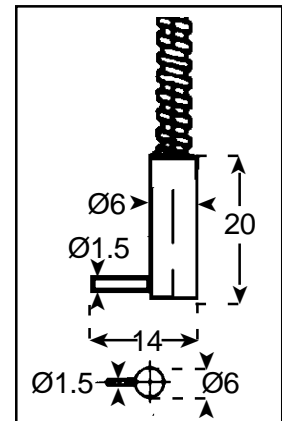

18/30 LZ/RZ 1 Si

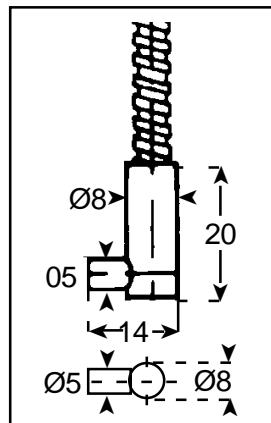

18/30 LZ/RZ 2 Si

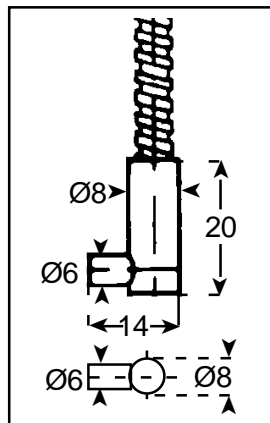

18/30 LZ/RZ 3 Si

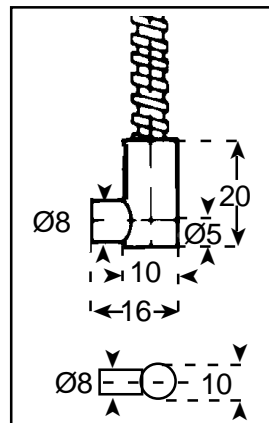

30 LZ/RZ 4 Si

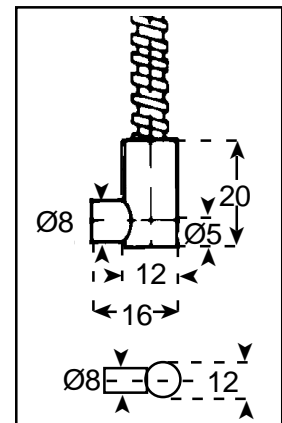

30 LZ/RZ 12 Si

## Type Ordering Code

Description in plain text	Suitable Function Sensor	Design	Fiber Optic Tip	Glass of Type	Length of Fiber Optic in mm *	Coating of Fiber	Side Length of Fiber Tip
Light Barrier Reflex-Scanner	<b>18/30:</b> Fits FMS 18 and FMS 30 <b>30:</b> Fits FMS 30 only	<b>L:</b> Light Barrier <b>R:</b> Reflex-Scanner	<b>Not specified:</b> Straight Tip <b>Z:</b> Right Angle Tip	0.5 1 1.5 2 3 4, 12	500 1000 1500 2000 * Longer lengths available in increments of 500 mm	Si Si	Ls = . . .

### Examples:

Light Barrier	30	L	Z	4/	2000 -	Si	Ls = 16
Reflex-Scanner	18/30	R		2/	500 -	Si	



Locon Sensor Systems, Inc., P.O. Box 343, Perrysburg, Ohio, 43552  
Phone: 800-356-2661 Fax: 216-359-0077 E-mail: Sales@Locon.net